

## ***Your Business is Located in the City's Wellhead Protection Delineation Area***

You are receiving this information because your business is located inside the purple area identified on the map below. The following two pages will describe what this means and how as a partner of the city your business can help protect the city's drinking water source.

### City of Fenton Wellhead Protection Team Mission Statement:

*"It is the mission of the City of Fenton to control the integrity of the City's water source through public awareness and education to ensure secure, clean, and reliable drinking water for present and future generations."*

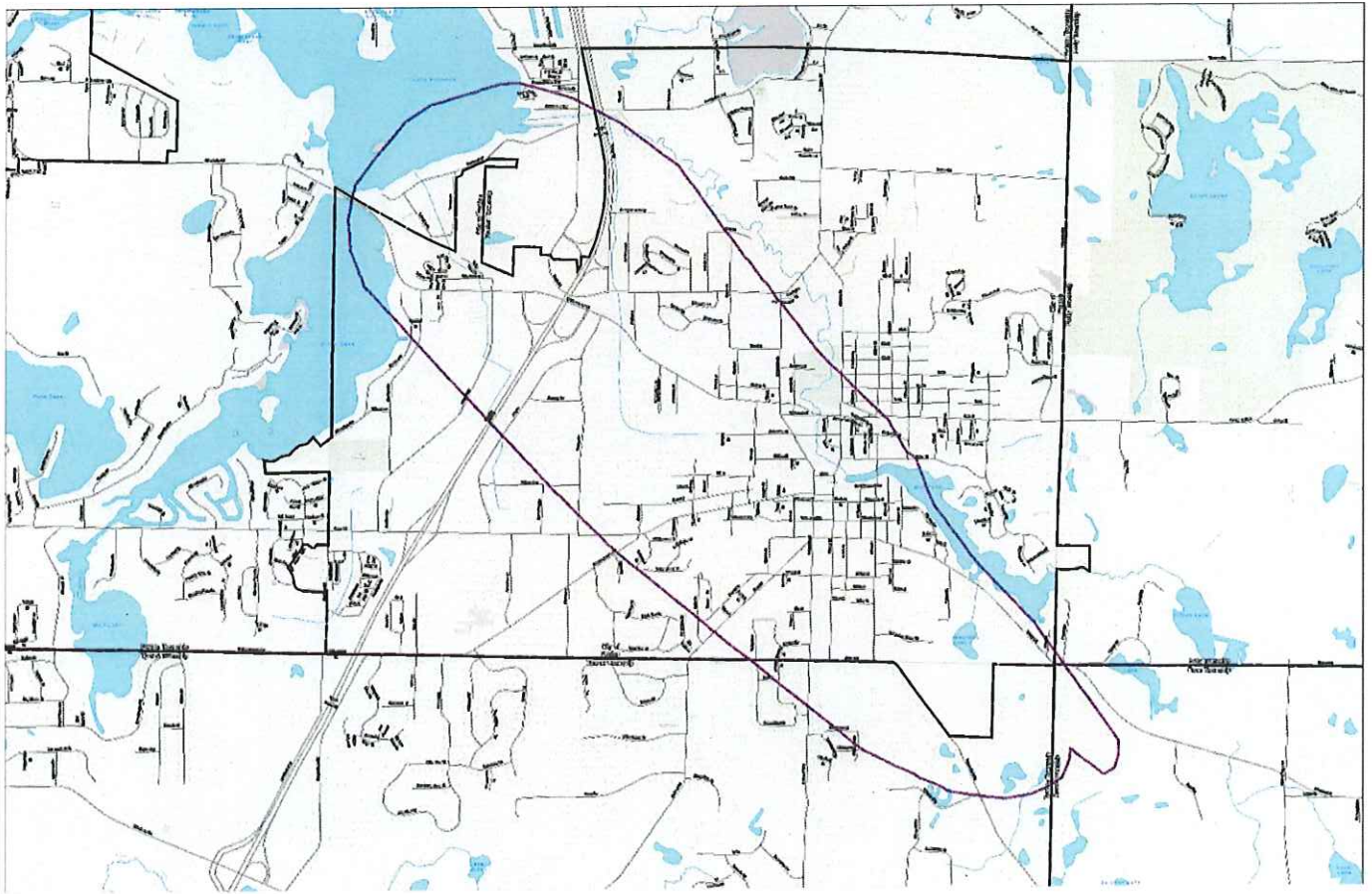

# *Wellhead Protection in the City of Fenton Information for Local Business Owners*

---

## *Where Does the City's Municipal Water Come From?*

The City extracts groundwater from four Type 1 groundwater wells that are installed in glacially deposited sands and gravels located below the City. The wells are connected to a water treatment plant owned and operated by the City that currently treats approximately 1.125 million gallons of groundwater for consumption by City businesses and residents each day. The City's water supply currently serves over 4,000 connections, of which over 500 are commercial and/or industrial users.



## *What is a Wellhead Protection Delineation Area?*

A Wellhead Protection Delineation Area (WHPDA) is the physical area that has been determined to contribute groundwater to the City's four municipal groundwater wells. The WHPDA is scientifically identified and consists of the surface and subsurface area surrounding a groundwater well (well field) supplying groundwater to a public water supply system, through which contaminants are reasonably likely to move toward and potentially impact the well(s).

## *Did You Know Your Business is Located in the City's WHPDA?*

Your business has been identified to be located within the City's Wellhead Protection Delineation Area (WHPDA). Because of this, your business has been identified as an important local partner in working towards protecting the City's groundwater resource.

## *What is a Wellhead Protection Plan?*

The purpose of a Wellhead Protection Plan (WHPP) is to provide a set of actions and management practices to protect the City's public water supply system, which uses groundwater, from potential sources of contamination.

## *Did You Know That the City Has a WHPP and WHP Team?*

The City has a Wellhead Protection Plan (WHPP) and an established Team to ensure continued success and implementation of the WHPP efforts. It is the mission of the City of Fenton to control the integrity of the City's water source through public awareness and education to ensure secure, clean, and reliable drinking water for present and future generations.

## *Why Does the City Need a Wellhead Protection Plan?*

The City's Wellhead Protection Plan (WHPP) has been put together to specifically address seven major elements which include: establishment of roles and responsibilities of the individuals responsible for implementation of the WHPP; development of a Wellhead Protection Delineation Area (WHPDA); identification of existing and potential sources of environmental contamination within the WHPDA; development of mechanisms to manage the WHPDA and minimize threats to the water system; development of contingency plans for water supply emergencies; identification of procedures for the development of new well sites; and to provide opportunities for public education and participation.

# *Wellhead Protection in the City of Fenton Information for Local Business Owners*

---

## ***What if the City's Groundwater Wells Were to Become Contaminated?***

The City has a contingency plan and an Emergency Response Plan (ERP) in place in the event that some form of environmental contamination were to be introduced within the Wellhead Protection Delineation Area (WHPDA) and reach the City's municipal wells. Responding to a contamination event would be extremely expensive versus the cost of protecting the groundwater resource.

---

## ***What Can Be Done by Local Business Owners to Help the City's WHPP Efforts?***

The following are suggested best management practices and things that can be done by local businesses to help the City's Wellhead Protection Plan (WHPP) efforts.

*Chemical Inventory* - Be sure to keep an adequate inventory of all chemicals, including the chemical names, Safety Data Sheets (SDS), along with the quantities used, stored and disposed of.

*Chemical Storage* – Develop and maintain a chemical storage area. Things to consider could be labeling of all chemicals, proper storage, separation of chemical types, and implementation of secondary containment as needed.

*Chemical Disposal* – Properly dispose of all used and/or unused chemicals. Do not dispose of chemicals in either floor drains, or in the City's sanitary or storm sewers. Properly maintain any chemical holding tanks.

*Spill Response Plans* – Develop and maintain Spill Response Plans as needed to ensure you and your employees are trained in how to react to a chemical spill.

*Promptly Report Spills* – Make sure that any and all accidental spills are reported immediately to allow quick emergency response activities.

*Stormwater Management* – Be sure to properly manage your stormwater to minimize potential environmental impacts related to stormwater runoff.

*Report any Unused Wells* – Report to the City any unused wells on your property as they are one of the greatest threats of contamination to the local groundwater resource. The City is currently creating an inventory of unused wells.

*Record Keeping* – Keep and maintain a filing system to document all of the above activities.

*Employee Training* – Train employees annually about the above suggested practices.

---

## ***What is The City's Wellhead Protection Overlay Zone Ordinance?***

The purpose and intent of the Wellhead Protection Overlay Zone is to provide supplemental development regulations as to permanently protect drinking water sources from contamination within the WHPDA. These regulations contain proactive measures, which apply to certain areas of the community, as well as those imposed in the underlying district.

---

## ***Where Can More Information about the City's WHPP Be Located?***

The City has a webpage on the internet devoted to the Wellhead Protection Plan (WHPP) efforts which can be located on the City's website under Wellhead Protection Program on the Department of Public Works webpage. For more information on the City's WHPP please contact the City's Water Plant at (810) 714-0528 with your inquiries.